

Trolleys

A Versatile And Heavy-Duty

ML 3.0 RT Tracked Carrier [3.0t]

The rugged ML 3.0 RT Tracked Carrier provides users with adaptability, heavy-duty carrying capability, and greater gradability in a compact package, making it a handy tool for heavy-duty hauling in rough terrain outdoor settings.

The ML 3.0 RT Tracked Carrier has a class-leading electric drive with two 5.3kW ultra-quiet IP67 rated AC electric motors. It can be fitted with either AGM or Lithium batteries, and has three power management setups for different speeds:

ECO @ 1.2 km/h / STD @ 2.0 km/h / POW @ 4.2 km/h

This cutting-edge electric tracked carrier has a fully replaceable battery pack with its own internal charger. This feature helps to prevent downtime for on-site users.

An additional support beam on each corner offers additional support for larger loads; they can be installed to make the loading area longer or wider. The platform itself is supported by a freely rotating slewing ring with 16 different locking settings to choose from, allowing you to tailor the platform to your load and traversing requirements.

The ML 3.0 RT Tracked Carrier's distinctive wide track design and higher ground clearance than the ML 3.0 FX provides enhanced accessibility and gradeability with rollers that actively adjust to the terrain, providing grip to assist in eliminating inadvertent load spills.

Technical Specifications

	ELC	LTH
Capacity	3000kg (up to 25°)	
Capacity at max gradient	2000kg	
Max longitudinal gradient	40°	
Max lateral gradient	25°	
Length	1860mm	
Width	890mm	
Height	510mm	
Track length	1230mm	
Track width	250mm	
Ground clearance	220mm	
Max speed	4.2km/h	
Swivel platform	Standard	
Power of electric motors	10.6kW	
Voltage	48V	
Battery capacity & type	AGM	Lithium
Charger (110-230v)	7hrs - 13A	4hrs - 20A
Ingress protection IP	IP67	
Controller	Radio remote control	
Weight (with battery)	975kg	805kg



The ML 3.0 RT with wider tracks and a higher ground clearance is ideal for carrying heavy loads while traversing rougher terrain.

Reference Codes

AGM Battery Code: TPS 3.0 RTE

LTH Battery Code: TPS 3.0 RTL

The platform of the ML 3.0 RT sits on a freely rotating slewing ring with 16 different lockable positions that the user can manually choose from, enabling you to adapt the platform to your own needs.





The ML 3.0 RT is fully controlled by radio remote.



Technical Data (mm)

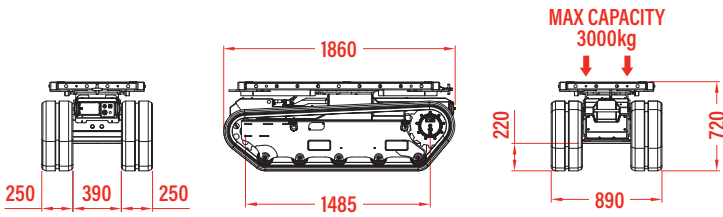

Removable Battery Pack

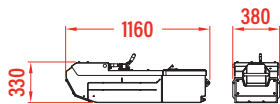

Removable Battery Pack Weights

ELC Battery Pack: 170kg
LTH Battery Pack: 100kg

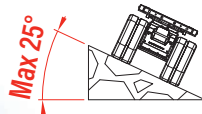
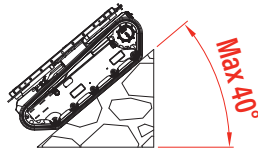
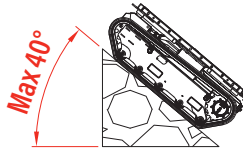
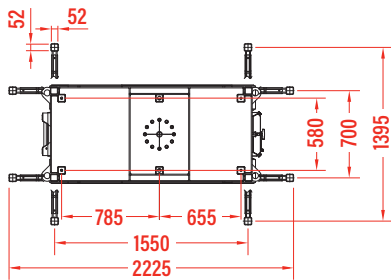

Key Features

- Max capacity: 3000kg (up to 25°), 2000kg (> 25°)
- Max speed: 4.2km/h
- Max gradient: 40° longitudinal, 25° lateral
- Rough terrain, wide tracks
- 360° slewing platform with 16 positions
- Three different driving modes: Main / ED-S / DC-S
- Three power management modes: Eco / Std / Pow
- 4 hours recharge time (LTH), 7 hours (ELC)
- Automatic tilt alarm with speed reduction
- Ground clearance: 220mm
- Weight with battery: 805kg (LTH), 975kg (ELC)

Platform Rotation

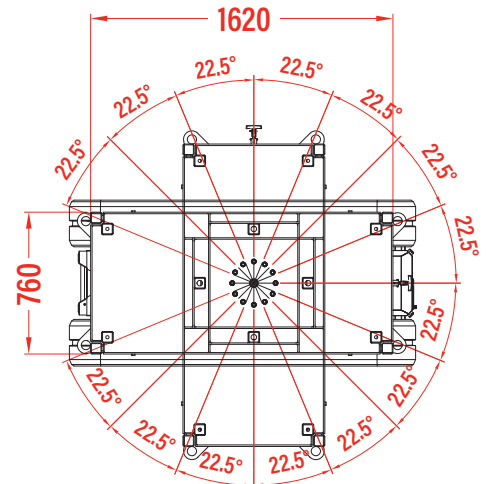

With a 220mm ground clearance, a wider base and 250mm wide tracks the ML 3.0 RT is perfectly adept at travelling over rough uneven ground and slippery floors, all while keeping loads safe and secure.

